



ORDINANCE NUMBER 34-2017

AN ORDINANCE TO CHANGE THE ZONING CLASSIFICATION OF PROPERTIES OWNED BY NEHEMIAH COMMUNITY REVITALIZATION CORPORATION LOCATED ON OAKLAND AVENUE FROM C-2 (COMMERCIAL DISTRICT) TO R-7.5 (SINGLE-FAMILY RESIDENTIAL DISTRICT).

The City Council of Greer makes the following findings:

This ordinance pertains to certain properties owned by Nehemiah Community Revitalization Corporation located on Oakland Avenue and more clearly identified by the attached City of Greer Map specifying Greenville County Parcel Numbers G014000406000 and G014000406100 containing approximately 0.63 acres attached hereto marked as Exhibit A.

1. The owner desires to change the zoning classification of the properties and has shown the need for such use to the Greer Planning Commission at a public hearing held on September 18, 2017.
2. To accomplish the desired change in use in the most effective manner, the zoning classification should be changed to R-7.5 (Single-Family Residential District).
3. The proposed use is in keeping with the general character of the surrounding property.

NOW, THEREFORE, be it ordained by the Mayor and Council of the City of Greer, South Carolina, as follows:

The zoning classification of the properties located on Oakland Avenue and more particularly identified by the attached City of Greer Map specifying Greenville County Parcel Numbers G014000406000 and G014000406100 containing approximately 0.63 acres attached hereto marked as Exhibit A shall be changed from C-2 (Commercial District) to R-7.5 (Single-Family Residential District).

This ordinance shall be effective immediately upon second reading approval.

CITY OF GREER, SOUTH CAROLINA

Richard W. Danner, Mayor

ATTEST:



Tammela Duncan, Municipal Clerk

Introduced by: Councilman Wayne Griffin

First Reading: October 10, 2017

Second and
Final Reading: October 24, 2017

Approved as to Form:

John B. Duggan
City Attorney

EXHIBIT

A

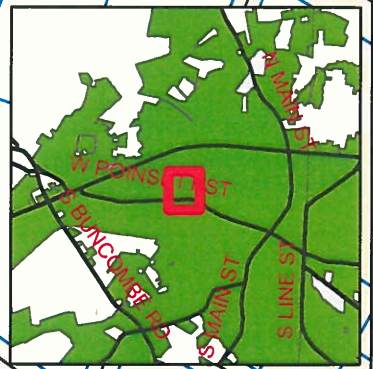
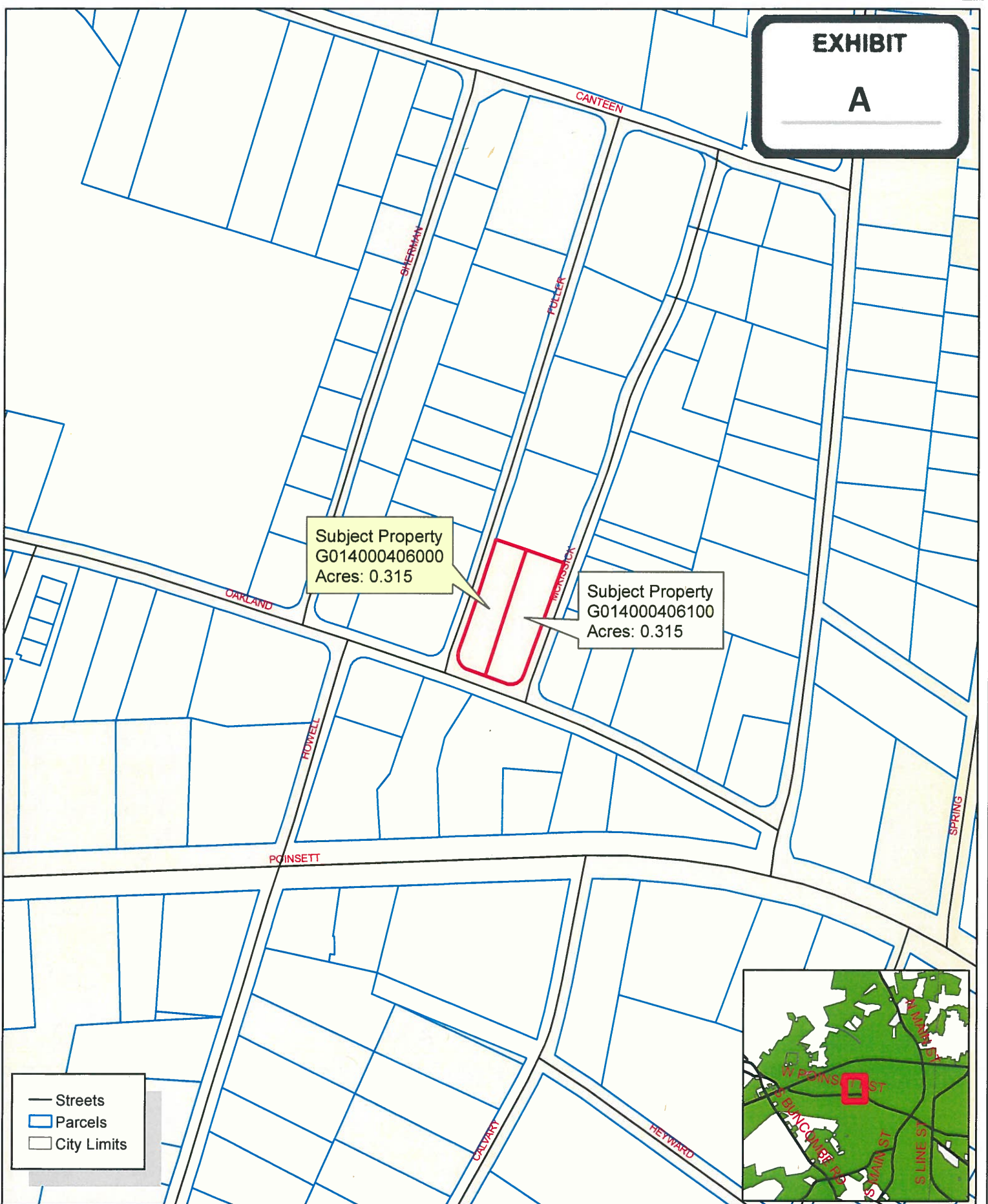

Ordinance 34-2017



The City of Greer Planning/Zoning Department does not guarantee the accuracy or the correctness of this map nor assumes any legal responsibility for the information contained on it. This map is not a legal document. This map is based on the South Carolina State Plane Coordinate System using the 1983 adjustment of the North American Datum. All rights reserved. No part of this map may be reproduced or used in any form or by any means without the expressed written consent of the City of Greer Planning/Zoning Department.