



ORDINANCE NUMBER 25-2015

AN ORDINANCE TO CHANGE THE ZONING CLASSIFICATION OF PROPERTY OWNED BY CARMELITA G. FOSTER LOCATED AT 107 FOREST STREET FROM C-2 (COMMERCIAL) TO R7.5 (RESIDENTIAL SINGLE FAMILY).

The City Council of Greer makes the following findings:

This ordinance pertains to a certain property owned by Carmelita G. Foster located at 107 Forest Street and more clearly identified by the attached City of Greer Map specifying Greenville County Parcel Number G014000402800 containing approximately .43 acres attached hereto marked as Exhibit A.

1. The owner desires to change the zoning classification of the property and has shown the need for such use to the Greer Planning Commission at a public hearing held on September 21, 2015.
2. To accomplish the desired change in use in the most effective manner, the zoning classification should be changed to R7.5 (Residential Single Family).
3. The proposed use is in keeping with the general character of the surrounding property.

NOW, THEREFORE, be it ordained by the Mayor and Council of the City of Greer, South Carolina, as follows:

The zoning classification of the property located at 107 Forest Street and more particularly identified by the attached City of Greer Map specifying Greenville County Parcel Number G014000402800 containing approximately .43 acres attached hereto as

Exhibit A shall be changed from C-2 (Commercial) to R7.5 (Residential Single Family).

This ordinance shall be effective immediately upon second reading approval.

CITY OF GREER, SOUTH CAROLINA

Richard W. Danner, Mayor

ATTEST:

Tammela Duncan, Municipal Clerk

Introduced by: Councilman Wayne Griffin

First Reading: October 27, 2015

Second and
Final Reading: November 10, 2015

Approved as to Form:



John B. Duggan
City Attorney

EXHIBIT
A



Subject Property
G014000402800
Acres: 0.43

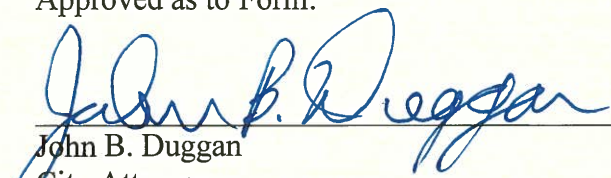
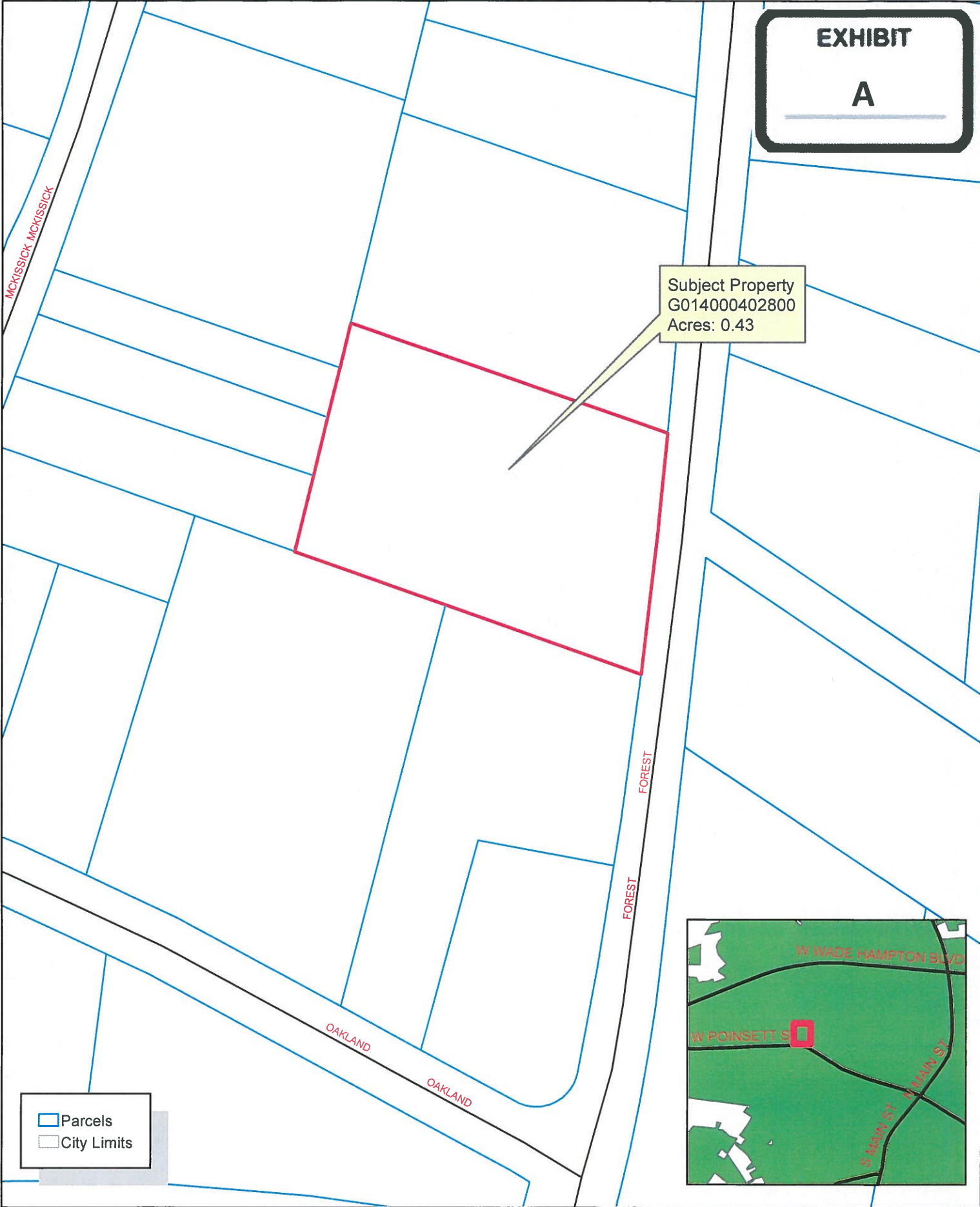
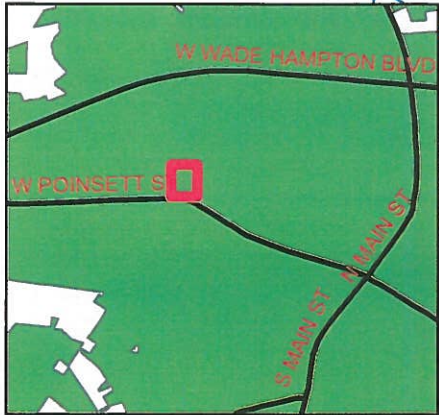

Parcels
City Limits



Ordinance 25-2015



The City of Greer Planning/Zoning Department does not guarantee the accuracy or the correctness of this map nor assumes any legal responsibility for the information contained on it. This map is not a legal document. This map is based on the South Carolina State Plane Coordinate System using the 1983 adjustment of the North American Datum. All rights reserved. No part of this map may be reproduced or used in any form or by any means without the expressed written consent of the City of Greer Planning/Zoning Department.