



ORDINANCE NUMBER 42-2012

AN ORDINANCE TO CHANGE THE ZONING CLASSIFICATION OF PROPERTY OWNED BY RANDY BREWER LOCATED AT EAST SUBER ROAD AND GIBB SHOALS ROAD FROM RM-2 (RESIDENTIAL, MULTI-FAMILY) TO R-5 (PATIO HOMES).

The City Council of Greer makes the following findings:

This ordinance pertains to a certain property owned by Randy Brewer located at East Suber Road and Gibb Shoals Road and more clearly identified by the attached Greenville County Tax Map as Parcel Number 05355030102000 containing approximately 3.47 acres attached hereto marked as Exhibit A.

1. The owner desires to change the zoning classification of the property and has shown the need for such use to the Greer Planning Commission at a public hearing held on November 19, 2012.
2. To accomplish the desired change in use in the most effective manner, the zoning classifications should be changed to R-5 (Patio Homes).
3. The proposed use is in keeping with the general character of the surrounding property.

NOW, THEREFORE, be it ordained by the Mayor and Council of the City of Greer, South Carolina, as follows:

The zoning classification of the property located at East Suber Road and Gibb Shoals Road and more particularly identified by the attached Greenville County Tax Map as Parcel Number 05355030102000 containing approximately 3.47 acres attached

hereto as Exhibit A shall be changed from RM-2 (Residential, Multi Family) to R-5 (Patio Homes).

This ordinance shall be effective immediately upon second reading approval.

CITY OF GREER, SOUTH CAROLINA

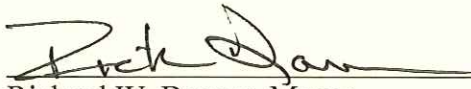
Richard W. Danner, Mayor

ATTEST:

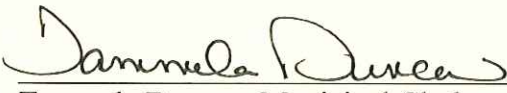
Tammela Duncan, Municipal Clerk

Introduced by: Councilman Wryley Bettis

First Reading: November 27, 2012

Second and
Final Reading: January 22, 2013

Approved as to Form:



John B. Duggan
City Attorney

EXHIBIT
A

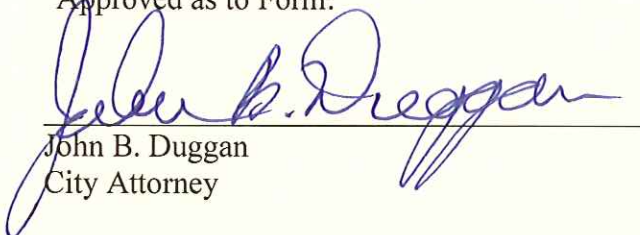
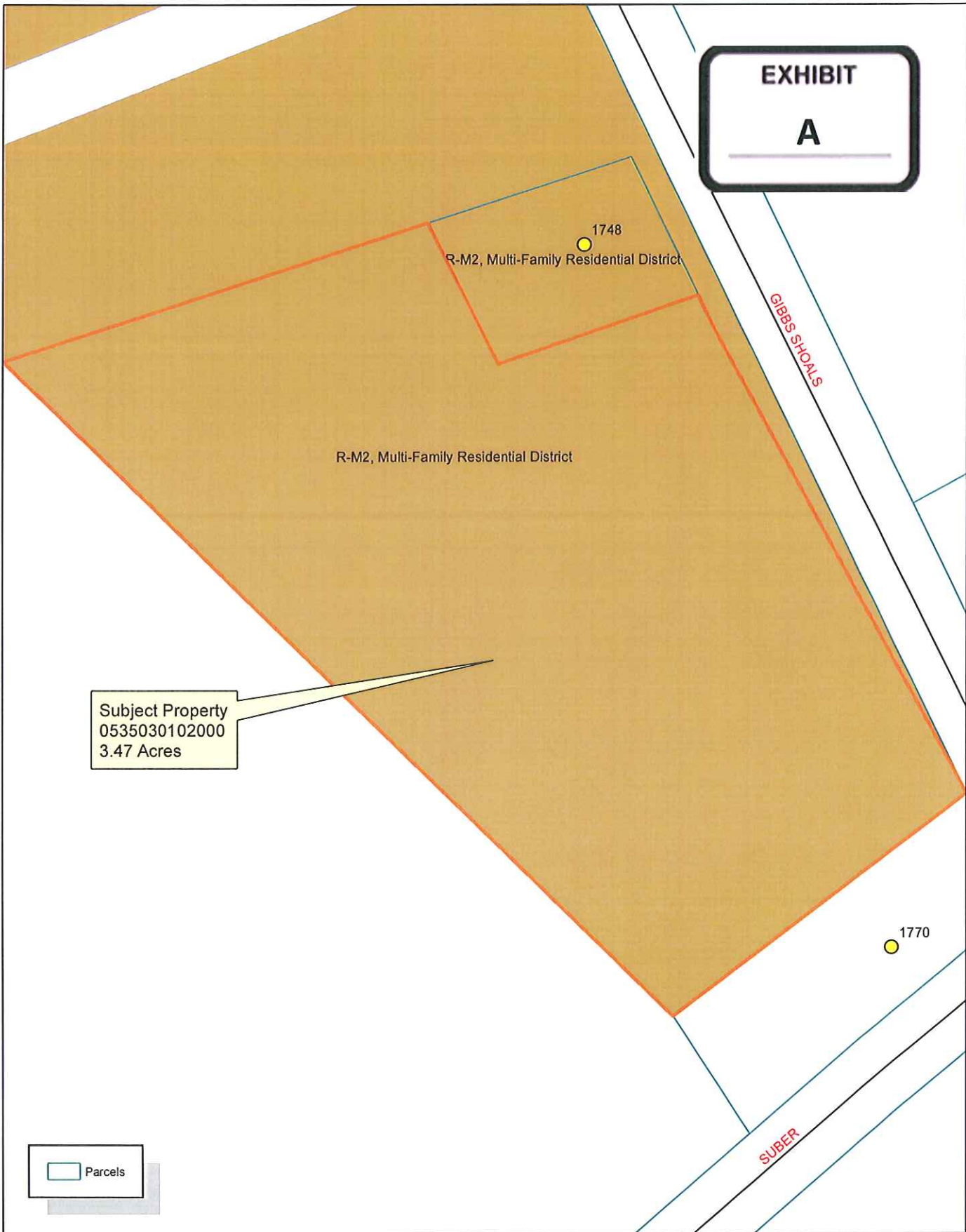

Subject Property
0535030102000
3.47 Acres

Parcels



RZ 2012-26

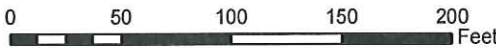

The City of Greer Planning/Zoning Department does not guarantee the accuracy or the correctness of this map nor assumes any legal responsibility for the information contained on it. This map is not a legal document. This map is based on the South Carolina State Plane Coordinate System using the 1983 adjustment of the North American Datum. All rights reserved. No part of this map may be reproduced or used in any form or by any means without the expressed written consent of the City of Greer Planning/Zoning Department.